

## 冲压外圈有密封圈滚针轴承 Drawn Cup Needle Roller Bearing With Seal Ring

⊙密封的冲压外圈滚针轴承带有密封唇密封。在一般条件下，可保护轴承免于杂物侵入和防止润滑脂的泄漏。密封圈采用合成橡胶制成，使用温度为-20℃~120℃。轴承供货时内部已注有高质量锂基脂。另外，冲压外圈滚针轴承以不带油孔为标准设计，双列冲压外圈滚针轴承以带油孔标准设计，如需改变请在订货时说明。

⊙HK---2RS穿孔型双面密封冲压外圈滚针轴承，HK---RS穿孔型单面密封冲压外圈滚针轴承，BK---RS封口型单面密封冲压外圈滚针轴承。

⊙The sealed drawn cup needle roller bearing is mounted with sealing lip. In general, the sealing lip can protect bearing from penetration of impurities and leakage of lubricating grease. The seal ring is made of synthetic rubber with operating temperature in -20℃~120℃. The bearings are fed with high-quality lithium base grease. In addition, it is standard design for drawn cup needle roller bearing without oil hole and doublerow drawn cup needle roller bearing with oil hole. It should be stated in order if changed.

- ⊙Model HK 2RS open-end double-seal drawn cup needle roller bearing,
- ⊙Model HK RS open-end single-seal drawn cup needle roller bearing,
- ⊙Model BK RS close-end single seal drawn cup needle roller bearing



### 冲压外圈有密封滚针轴承 Drawn Cup Needle Roller Bearings With Seal Ring

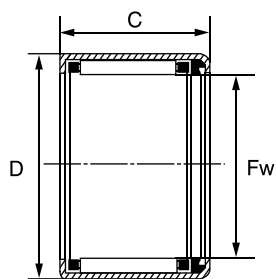

HK---RS

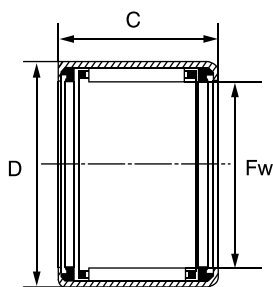

HK---2RS

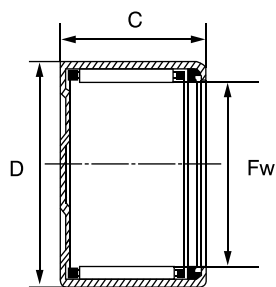

BK---RS

轴径 Shaft Diameter	轴承型号 Bearing Designation	重量 Mass 近似 Approx	外形尺寸 Boundary Dimensions			基本额定负荷 Basic Load Rating		极限转速 Limiting Speed
	现型号 Current Code		Fw	D	C	动 Dynamic	静 Static	油润 滑 Oil
mm		g	mm			N		rpm
8	HK0810 RS	2.9	8	12	10	2250	2100	19000
	HK0812 2RS	3.5	8	12	12	2250	2100	19000
9	HK09X13X12 RS	4	9	13	12	3800	4300	19000
10	HK1012 RS	4.2	10	14	12	4100	5000	19000
	HK1014 2RS	5.2	10	14	14	4100	5000	15000
12	HK1214 RS	10.7	12	18	14	6100	7000	15000
	HK1216 2RS	11.5	12	18	16	6100	7000	12000
13	HK13X19X12 RS	8.9	13	19	12	6800	7580	12000
14	HK1414 RS	12	14	20	14	6100	7500	13000
	HK1416 2RS	14	14	20	16	6100	7500	11000
	BK1414 RS	14.1	14	20	14	6100	7500	11000
15	HK1514 RS	12.6	15	21	14	6800	8800	11000
	HK1516 2RS	14.3	15	21	16	6800	8800	10000
	BK1514 RS	14.4	15	21	14	6800	8800	10000
	HK1518 RS	16	15	21	18	9500	11400	10000
	HK1520 2RS	18	15	21	20	9500	11400	10000
16	HK1614 RS	15.1	16	22	14	7200	9200	10000
	HK1616 2RS	15.1	16	22	16	7200	9200	10000
	BK1614 RS	15.3	16	22	14	7200	9200	10000
	HK1620 2RS	16.8	16	22	20	9900	12300	10000
	HK1625 2RS		16	22	25	9900	12300	10000
17	HK17X25X14 RS	17.7	17	25	14	8000	9800	10000
	HK17X25X15.5 RS	20	17	25	15.5	9320	10400	13000
	HK17X25X18 RS	23.5	17	25	18	10500	12600	13000
	HK17X25X20 RS	26.2	17	25	20	11600	13200	13000
18	HK1814 RS	15.1	18	24	14	7800	9900	13000
	HK1816 2RS	17	18	24	16	7800	9900	9200
20	HK201 2RS	11.7	20	26	12	9500	11900	9200
	HK2016 2RS	18.8	20	26	16	8000	10100	9000
	HK2018 RS	21.4	20	26	18	12700	20100	8200
	HK2020 2RS	23.5	20	26	20	12700	20100	7800
	BK2018 RS	24.4	20	26	18	12700	20100	7800
	HK20X29X18 RS	28.8	20	29	18	8700	9980	7800
22	HK2212 RS	14	22	28	12	8310	10000	9000
	HK2214 RS	18.3	22	28	14	9000	12400	7800
	HK2216 2RS	20.3	22	28	16	9000	12400	7800
	HK2218 RS	23.5	22	28	18	10400	20100	7800
	HK2220 2RS	25.5	22	28	20	10400	20100	7800
25	HK2516 2RS	27.3	25	32	16	9800	13200	6900

冲压外圈有密封滚针轴承  
Drawn Cup Needle Roller Bearings With Seal Ring

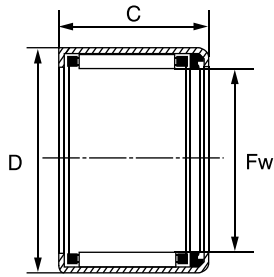

HK---RS

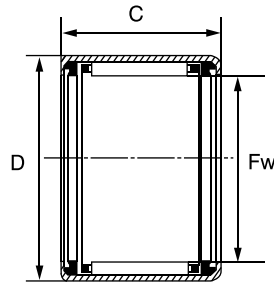

HK---2RS

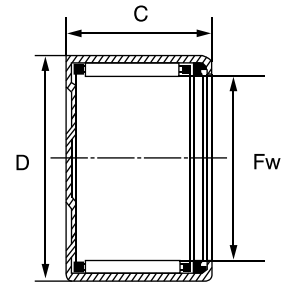

BK---RS

轴径 Shaft Diameter	轴承型号 Bearing Designation	重量 Mass 近似 Approx	外形尺寸 Boundary Dimensions			基本额定负荷 Basic Load Rating		极限转速 Limiting Speed
	现型号 Current Code		Fw	D	C	动 Dynamic	静 Static	油润滑 Oil
mm		g	mm			N		rpm
25	HK2518 RS	31	25	32	18	13600	20000	6900
	HK2520 2RS	33.1	25	32	20	13600	20000	6900
	BK2518 RS	35.3	25	32	18	13600	20000	6900
	HK2524 2RS	39.7	25	32	24	17900	30000	6900
	HK2530 2RS	47.3	25	32	30	24500	43000	6900
28	HK2820 2RS	36.9	28	35	20	11400	22500	5300
30	HK3016 2RS	28.5	30	37	16	10100	16200	5300
	HK3018 RS	36.6	30	37	18	16200	26000	5300
	HK3020 2RS	39.1	30	37	20	16200	26000	5300
	HK3024 2RS	49.7	30	37	24	21000	38500	5300
35	HK3516 2RS	36.4	35	42	16	10100	20300	4900
	HK3518 RS	37.4	35	42	18	16700	30500	4900
	HK3520 2RS	41.1	35	42	20	16700	30500	4900
40	HK4016 2RS	41.2	40	47	16	11000	21300	4200
	HK4018 RS	47.3	40	47	18	19000	30500	4200
	HK4020 2RS	50.2	40	47	20	19000	30500	4200
45	HK4518 RS	54.2	45	52	18	20300	41000	3800
	HK4520 2RS	57.4	45	52	20	20300	41000	3800
50	HK5022 RS	77.2	50	58	24	30000	61000	3200
	HK5024 2RS	84	50	58	24	30000	61000	3200